

CLIA 2025

12th - 14th March 2025

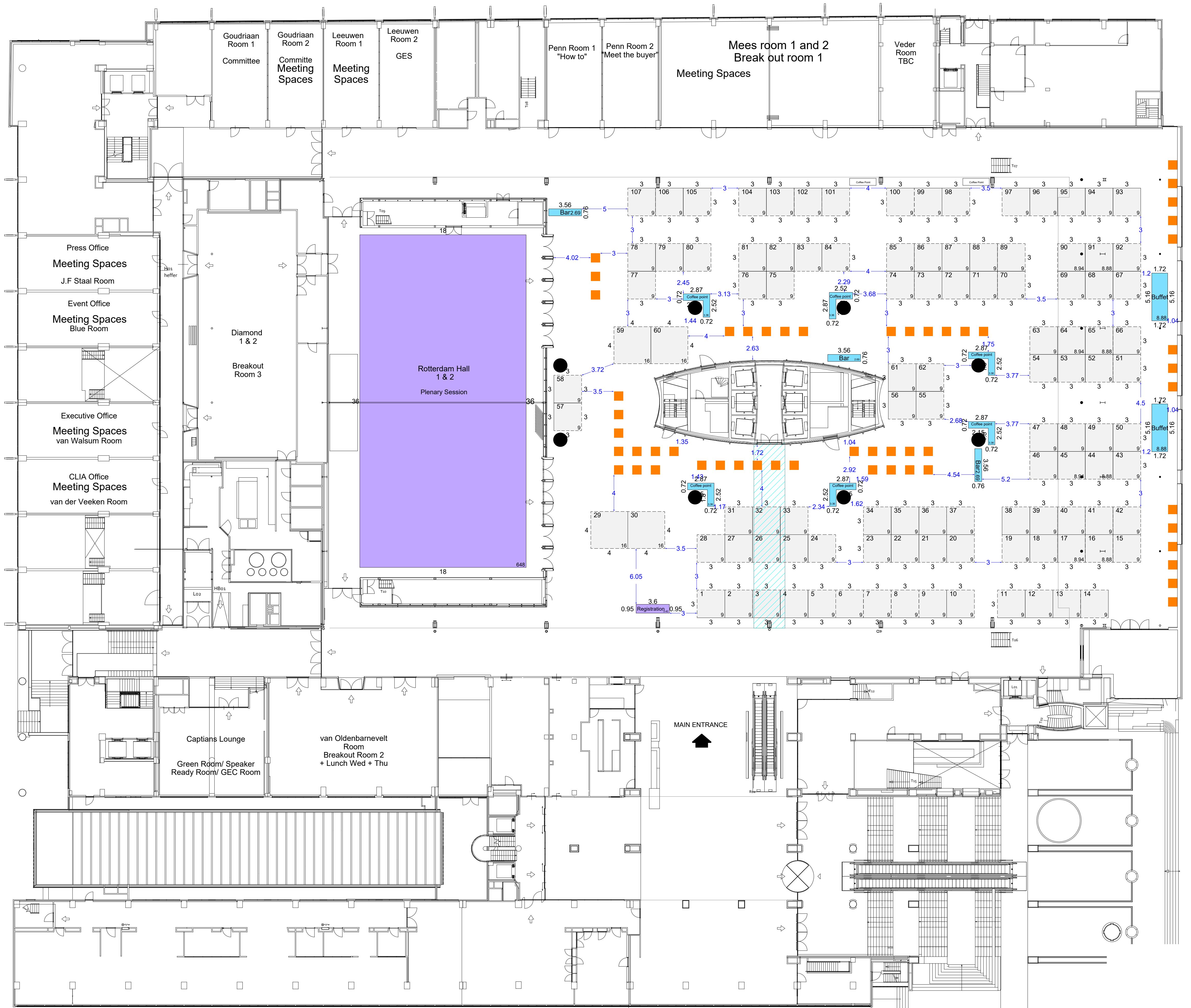

Available (990.28m ²) (Qty: 107)	Shell (0m ²) (Qty: 0)	Storage (0m ²) (Qty: 0)
Catering (45.99m ²) (Qty: 11)	Shell - AMP (0m ²) (Qty: 0)	Void (0m ²) (Qty: 0)
Feature (651.42m ²) (Qty: 2)	Show Ready (0m ²) (Qty: 0)	Walling (GES Only) (0m ²) (Qty: 0)
Seating (0m ²) (Qty: 0)	Space only (0m ²) (Qty: 0)	